

- Key**
- Key - Carriageway Surfacing**
- Plane 300mm (Approx. 465m²) and excavate to formation, replace with:
 - 45mm HRA 35/14 surf PMB 40/60 des 68+ PSV Clause 943
 - 85mm AC20 HDM bin 40/60 Clause 929
 - 160mm AC32 HDM base 40/60 Clause 929 (Laid in two layers)
 - 220mm Type 1 Sub base
 - 200mm Capping Class '6F5'
 - Plane 130mm (Approx. 271m²) and replace with:
 - 45mm HRA 35/14 surf PMB 40/60 des 68+ PSV Clause 943
 - 85mm AC20 HDM bin 40/60 Clause 929
 - Plane 130mm (Approx. 1236m²) and replace with:
 - 45mm HRA 35/14 surf PMB 40/60 des 65 PSV Clause 943
 - 85mm AC20 HDM bin 40/60 Clause 929
 - C?? 2014 Core location
 - C?? 2019 Core location
- Key - Ironwork and Drainage**
- All gullies and manholes to be cleaned, and connections and main run to be jetted.
- G Existing gully
 - Grp Gully - grating and frame to be removed to recycling centre off site and replaced with new D400 cover and frame.
 - Grs Gully - grating and frame to be reset

- NOTES - GENERAL**
- Do not scale from this drawing. If in doubt contact telford and wrekin council - highways, transportation and engineering (twc - hte).
 - All dimensions are in metres (m) unless otherwise noted.
 - This drawing is to be read in conjunction with all other relevant drawings relating to this project.
 - All dimensions should be checked on site prior to construction. Any discrepancies are to be immediately reported in writing to twc - hte.
 - The contractor shall, prior to construction, check and verify that the details shown on this drawing are fully compatible with any as constructed dimensions or levels. Any discrepancies are to be immediately reported in writing to twc - hte.
 - This drawing has been prepared for the exclusive use of the commissioning party and unless agreed in writing by twc - hte no other party may use or rely on its contents. No liability is accepted by twc - hte for any use of this drawing other than for the purpose for which it was originally prepared.
 - It should be noted that this drawing may include data provided by third parties. No liability is accepted by twc - hte as to the accuracy of this data.
 - This drawing shall not be reproduced in any way without the written permission of twc - hte.

- NOTES - CARRIAGEWAY**
- This drawing should only be read in relation to the subject of the title. Other information shown on the drawing is to be considered indicative only. Reference should be made to appropriate drawing series for other information.
 - All patching/resurfacing, kerbing and ironwork must be marked out in the presence of the Project Manager and agreed prior to the commencement of any works on site.
 - Bond Coat to MCHW Clause 920 is required at all bound layer interfaces within the pavement, this includes planned surfaces and new asphalt layers.
 - All joints, kerbs and ironwork must be cleaned of dust and debris and all vertical faces to be painted with bitumen prior to resurfacing.
 - Planned surface must be swept clean and inspected immediately following planing in order to determine the extents of any areas of deep patching. Any loose or delaminating material should be brought to the attention of the Project Manager and must also be removed.
 - All bituminous materials to be transported, laid and compacted in accordance with BS 5948:2015
 - All ironwork to BS EN 124:2015

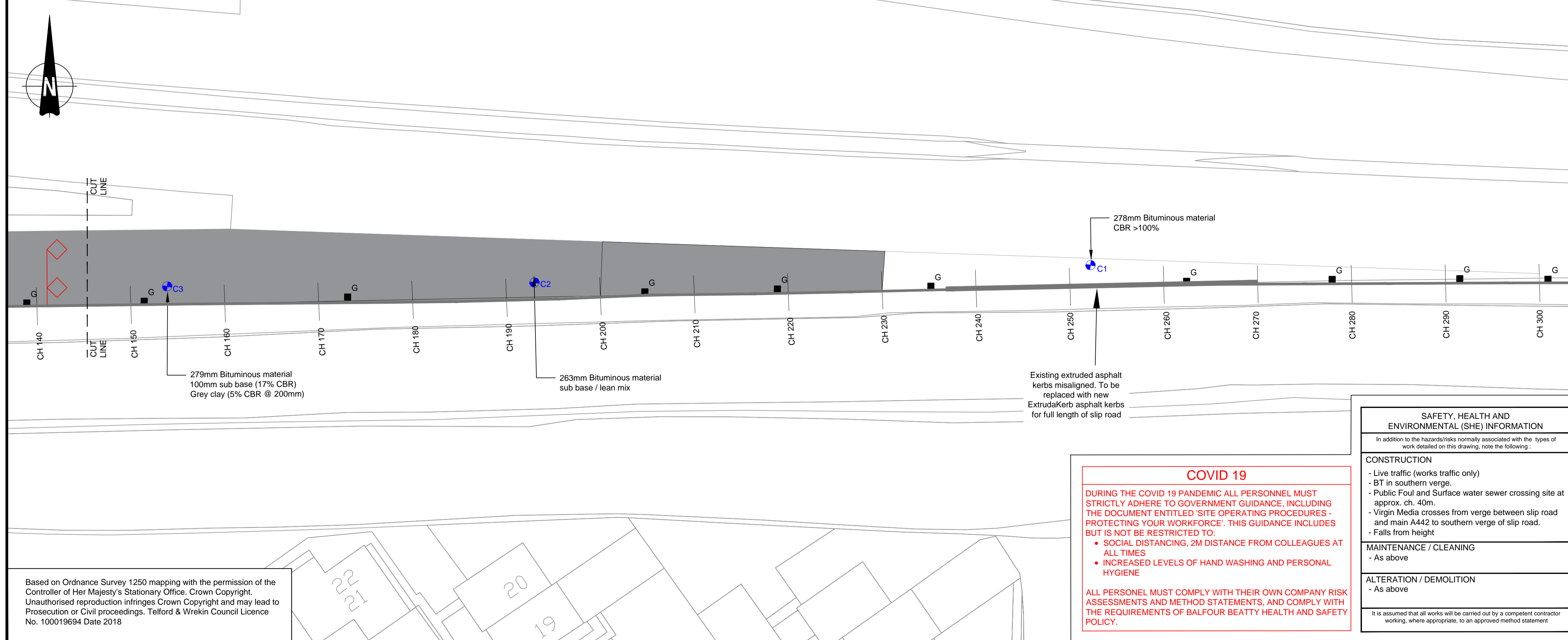

Rev	Revision/Issue Date	Purpose of Revision/Issue	Drawn	Checked	Approved
P3	05/08/2020	Amendments to treatment areas	C.Parkes	S.Wilkins	N.Lyttle
P2	24/06/2020	Addition of Core notes, extension of 65 and 60+PSV areas by 10m.	C.Parkes	S.Wilkins	N.Lyttle



Client		Telford & Wrekin Council	
Project		HM20/21 - A442 Hollinswood Northbound Offslip	
Drawing title		Pavement Drawing	
Drawing status		A- For Construction	
Scale	1:250	Date	19/03/2020
Drawn-by	C.Parkes	Checked-by	S.Wilkins
Approved-by	S.Asad		
DO NOT SCALE FROM THIS DRAWING			
Drawing number			HOLNB-TWC-A442-HPV-00-DR-CH-0700
			Rev C1

SAFETY, HEALTH AND ENVIRONMENTAL (SHE) INFORMATION

In addition to the hazards/risks normally associated with the types of work detailed on this drawing, note the following:

CONSTRUCTION

- Live traffic (works traffic only)
- BT in southern verge.
- Public Foul and Surface water sewer crossing site at approx. ch. 40m.
- Virgin Media crosses from verge between slip road and main A442 to southern verge of slip road.
- Falls from height

MAINTENANCE / CLEANING

- As above

ALTERATION / DEMOLITION

- As above

It is assumed that all works will be carried out by a competent contractor working, where appropriate, to an approved method statement

COVID 19

DURING THE COVID 19 PANDEMIC ALL PERSONNEL MUST STRICTLY ADHERE TO GOVERNMENT GUIDANCE, INCLUDING THE DOCUMENT ENTITLED 'SITE OPERATING PROCEDURES - PROTECTING YOUR WORKFORCE'. THIS GUIDANCE INCLUDES BUT IS NOT BE RESTRICTED TO:

- SOCIAL DISTANCING, 2M DISTANCE FROM COLLEAGUES AT ALL TIMES
- INCREASED LEVELS OF HAND WASHING AND PERSONAL HYGIENE

ALL PERSONNEL MUST COMPLY WITH THEIR OWN COMPANY RISK ASSESSMENTS AND METHOD STATEMENTS, AND COMPLY WITH THE REQUIREMENTS OF BALFOUR BEATTY HEALTH AND SAFETY POLICY.

Based on Ordnance Survey 1250 mapping with the permission of the Controller of Her Majesty's Stationary Office. Crown Copyright. Unauthorised reproduction infringes Crown Copyright and may lead to Prosecution or Civil proceedings. Telford & Wrekin Council Licence No. 100019694 Date 2018