

Core Log Summary - A5 Telford Way

Core No	Chainage (m)	Surface Course depth (mm)	Total Bituminous bound depth (mm)	DCP (Depths below bound layers noted)	Defect Information	BaP (mg/kg) Layer 1	BaP (mg/kg) Layer 2	BaP (mg/kg) Layer 3	BaP (mg/kg) Layer 4	BaP (mg/kg) Layer 5	BaP (mg/kg) Layer 6	BaP (mg/kg) Layer 7
1SB	140	0-46	334	Median CBR 51%, layer thickness 600mm.	Bond break at 105mm and 146mm. TBM possible 0-334mm				2			
2SB	197	0-45	320		Bond break at 101mm and 200mm. TBM possible 0-320mm			2				
3SB	350	0-47	359		Bond break at 75mm, 115mm, 176mm & 282mm. TBM possible 0-359mm				2			
4SB	180	0-40	317		Bond break at 70mm, 106mm & 160mm. TBM possible 0-317mm				2			
5SB		0-46	304		No defects, bond at 95mm is good. TBM possible 0-304mm				2			
1NB	75	0-54	333	Median CBR 17%, layer thickness 580mm.	Bond at 101mm is good. Bond break at 184mm. TBM possible 0-333mm			2				
2NB	185	0-45	369		Bond at 95mm is good. Bond break at 184mm. TBM possible 0-369mm				2			
3NB	343	0-35	311		Bond at 103mm is good. Bond break at 160mm & 230mm. TBM possible 0-311mm				2			
4NB	180	0-49	346	Median CBR 26%, layer thickness 580mm.	Bond breaks at 105mm, 161mm, 220mm & 234mm. Disintegrating from 150mm. TBM possible 0-346mm				2			
5NB	325	0-74	373		Bond at 101mm is good. Bond break at 74mm, 205mm & 275mm. TBM possible 0-373mm				2			

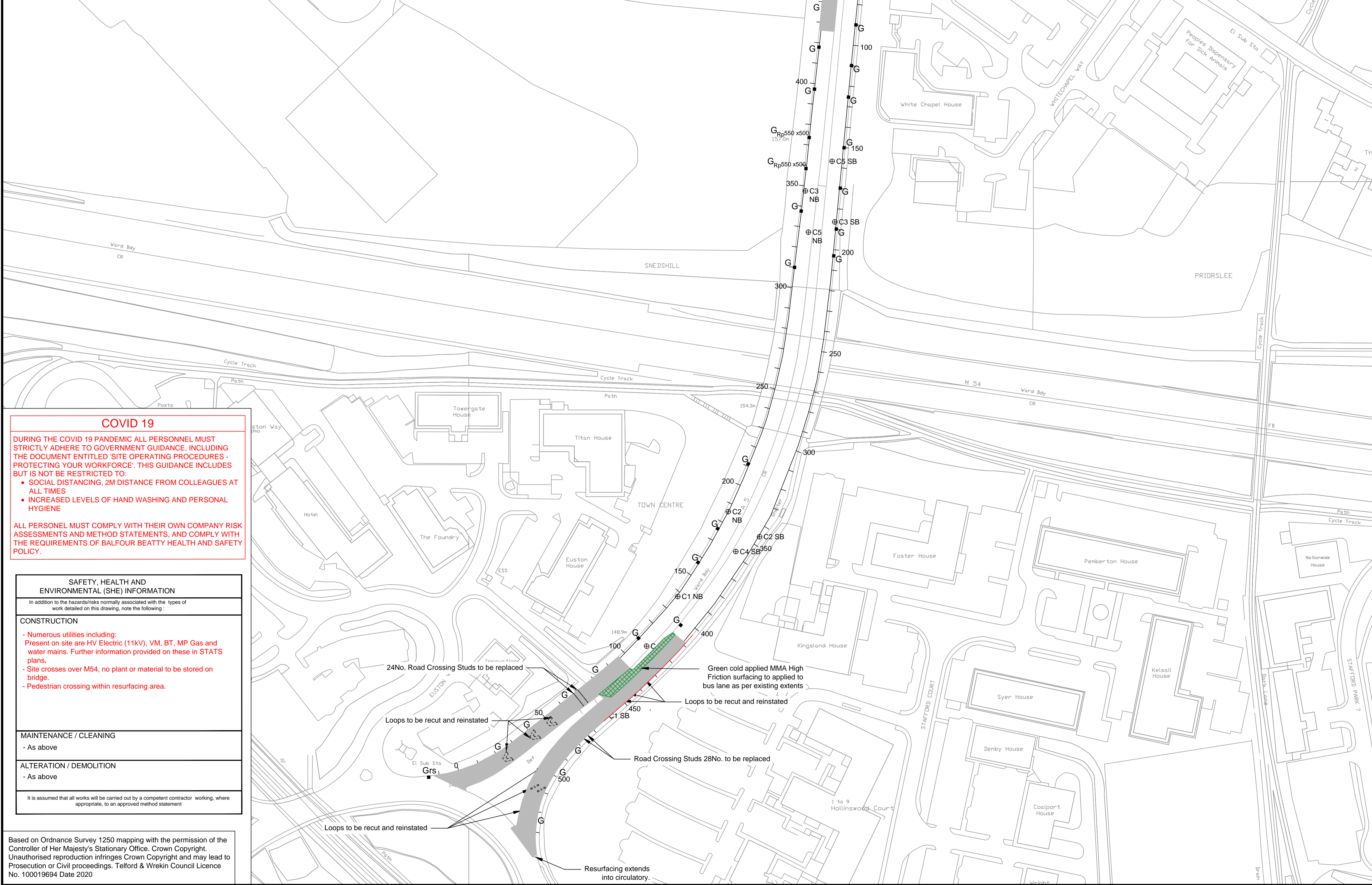

COVID 19

DURING THE COVID 19 PANDEMIC ALL PERSONNEL MUST STRICTLY ADHERE TO GOVERNMENT GUIDANCE, INCLUDING THE DOCUMENT ENTITLED 'SITE OPERATING PROCEDURES - PROTECTING YOUR WORKFORCE'. THIS GUIDANCE INCLUDES BUT IS NOT BE RESTRICTED TO:

- SOCIAL DISTANCING, 2M DISTANCE FROM COLLEAGUES AT ALL TIMES
- INCREASED LEVELS OF HAND WASHING AND PERSONAL HYGIENE

ALL PERSONEL MUST COMPLY WITH THEIR OWN COMPANY RISK ASSESSMENTS AND METHOD STATEMENTS, AND COMPLY WITH THE REQUIREMENTS OF BALFOUR BEATTY HEALTH AND SAFETY POLICY.

SAFETY, HEALTH AND ENVIRONMENTAL (SHE) INFORMATION	
In addition to the hazards/risks normally associated with the types of work detailed on this drawing, note the following:	
CONSTRUCTION	
<ul style="list-style-type: none"> - Numerous utilities including: - Present on site are HV Electric (11kV), VM, BT, MP Gas and water mains. Further information provided on these in STAS plans. - Site crosses over M54, no plant or material to be stored on bridge. - Pedestrian crossing within resurfacing area. 	
MAINTENANCE / CLEANING	
- As above	
ALTERATION / DEMOLITION	
- As above	
It is assumed that all works will be carried out by a competent contractor working, where appropriate, to an approved method statement	

Based on Ordnance Survey 1250 mapping with the permission of the Controller of Her Majesty's Stationary Office. Crown Copyright. Unauthorised reproduction infringes Crown Copyright and may lead to Prosecution or Civil proceedings. Telford & Wrekin Council Licence No. 100019694 Date 2020

- Notes
- Plane 110mm (Approx. 3324m2) and replace with: 40mm SMA10 surf PMB 68+PSV Clause 9711TAR 70mm AC20 HDM bin 40/60 Clause 929
 - Resurfacing as per above with Green cold applied MMA High Friction surfacing to applied to bus lane as per existing extents (Approx. 160m2)
 - G Existing gully
 - Grp Gully - grating and frame to be reset
 - Grp Gully - grating and frame to be removed to recycling centre off site and replaced with new D400 cover and frame 500mm x 500mm x 150mm.
 - @C?? Core location
- Additional Works:
- 350 linear m HAPAS approved overbanding repair 100mm wide, locations to be confirmed during ECI

- NOTES - GENERAL
- Do not scale from this drawing. If in doubt contact telford and wrekin council - highways, transportation and engineering (twc - hte).
 - All dimensions are in metres (m) unless otherwise noted.
 - This drawing is to be read in conjunction with all other relevant drawings relating to this project.
 - All dimensions should be checked on site prior to construction. Any discrepancies are to be immediately reported in writing to twc - hte.
 - The contractor shall, prior to construction, check and verify that the details shown on this drawing are fully compatible with any as constructed dimensions or levels. Any discrepancies are to be immediately reported in writing to twc - hte.
 - This drawing has been prepared for the exclusive use of the commissioning party and unless agreed in writing by twc - hte no other party may use or rely on its contents. No liability is accepted by twc - hte for any use of this drawing other than for the purpose for which it was originally prepared.
 - It should be noted that this drawing may include data provided by third parties. No liability is accepted by twc - hte as to the accuracy of this data.
 - This drawing shall not be reproduced in any way without the written permission of twc - hte.

- NOTES - CARRIAGEWAY
- This drawing should only be read in relation to the subject of the title. Other information shown on the drawing is to be considered indicative only. Reference should be made to appropriate drawing series for other information.
 - All patching/resurfacing, kerbing and ironwork must be marked out in the presence of the Project Manager and agreed prior to the commencement of any works on site.
 - Bond Coat to MCHW Clause 920 is required at all bound layer interfaces within the pavement, this includes planed surfaces and new asphalt layers.
 - All joints, kerbs and ironwork must be cleaned of dust and debris and all vertical faces to be painted with bitumen prior to resurfacing.
 - Planned surface must be swept clean and inspected immediately following planing in order to determine the extents of any areas of deep patching. Any loose or delaminating material should be brought to the attention of the Project Manager and must also be removed.
 - All bituminous materials to be transported, laid and compacted in accordance with BS 59487:2015
 - All ironwork to BS EN 124:2015

Rev	Revision/Issue Date	Purpose of Revision/Issue	Drawn	Checked	Approved
C1	20.04.21	PAH results amended in core summary table. Issued 'For Construction'	SW	NL	NL
P2	31.03.21	Green surfacing detail added to bus lane, core summary table amended with PAH.	SW	NL	NL

Telford & Wrekin Council logo and 'Pride in Our Community' slogan.

Dean Sergeant, Director, Neighbourhood & Enforcement Services, Addenbrooke House, Telford, TF3 4NT

Telford & Wrekin Council

Project: **HM21/22 - A5 Telford Way**

Drawing title: **Resurfacing Scheme**

Drawing status: **A - FOR CONSTRUCTION**

Scale: 1:1000 | A1 | Date: 05/03/2021 | Drawn by: T. Showering | Checked by: S. Wilkins | Approved by: N. Lytle

DO NOT SCALE FROM THIS DRAWING

Drawing number: **TELWY-TWC-HPV-01-DR-CH-0700** | Rev: **C1**