

Traffic Management

This drawing has been produced for a specific client & project identified below and is not intended for use by any other person or for any other purpose.

- NOTES
- All signs as per Chapter 8. Distances between cones to be 5m maximum unless otherwise noted.
 - Distances between signs NOT to scale for purpose of clarity.
 - All sign placement subject to available safe working space.
 - The purpose of the Traffic Management Plan is for it to be used only as a guide and all traffic management equipment should be put out according to the 'Safety at Street Works and Road Works - Code of Practice', i.e. Red Book & the 'Traffic Signs Manual Chapter 8', i.e. Yellow Book.

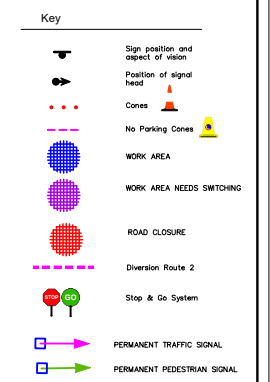

THIS DRAWING MUST BE PRINTED IN COLOUR
ALL SIGNAGE TO BE IN WELSH AND ENGLISH

NTS @ A3
NTS - OTHER SIZES
DO NOT SCALE FROM THIS DRAWING -
All Dimensions to be verified on site.

A	AS DRAWN
REV	DATE DESCRIPTION



TRAFFIC MANAGEMENT PLAN

Client:	
Drawing Number:	QTM-406-01
Drawing Title:	A442 STIRCHLEY NORTHBOUND TELFORD TF3 2DE LANE 2 CLOSURE DIVERSION
Design:	C. DE-COURCY MBE
Technical Officer:	
REV:	
Name:	C. DE-COURCY MBE
Signature:	
Date:	22/10/2021