

Traffic Management

This drawing has been produced for a specific client & project identified below and is not intended for use by any other person or for any other purpose.

- NOTES
1. All signs as per Chapter 8. Distances between cones to be 5m maximum unless otherwise noted.
 2. Distances between signs NOT to scale for purpose of clarity.
 3. All sign placement subject to available safe working space.
 4. The purpose of the Traffic Management Plan is for it to be used only as a guide and all traffic management equipment should be put out according to the 'Safety at Street Works and Road Works - Code of Practice', i.e. Red Book & the 'Traffic Signs Manual Chapter 8', i.e. Yellow Book.

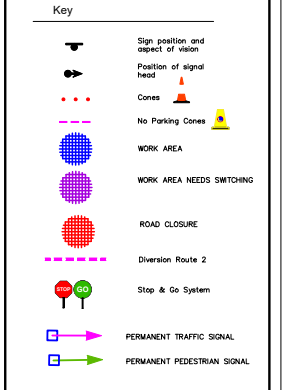

THIS DRAWING MUST BE PRINTED IN COLOUR
ALL SIGNAGE TO BE IN WELSH AND ENGLISH

NTS @ A3
NTS - OTHER SIZES
DO NOT SCALE FROM THIS DRAWING -
All Dimensions to be verified on site.

A	AS DRAWN
REV	DATE DESCRIPTION



TRAFFIC MANAGEMENT PLAN

Client:

Drawing Number: QTM-389-01
Drawing Title: A442 SOUTHBOUND TELFORD TF3 2DE LANE 2 CLOSURE

Design:	Technical Officer:	REV:
Name: C. DE-COURCY AMSE		A
Signature:		
Date: 29/09/2021		

BASED UPON THE ORDNANCE SURVEY MAP WITH THE PERMISSION OF THE CONTROLLER OF H.M. STATIONERY OFFICE.