

**Traffic Management**

This drawing has been produced for a specific client & project identified below and is not intended for use by any other person or for any other purpose.

- NOTES**
- All signs as per Chapter 8. Distances between cones to be 5m maximum unless otherwise noted.
  - Distances between signs NOT to scale for purpose of clarity.
  - All sign placement subject to available safe working space.
  - The purpose of the Traffic Management Plan is for it to be used only as a guide and all traffic management equipment should be put out according to the 'Safety at Street Works and Road Works - Code of Practice', i.e. Red Book & the 'Traffic Signs Manual Chapter 5', i.e. 'Yellow Book'.

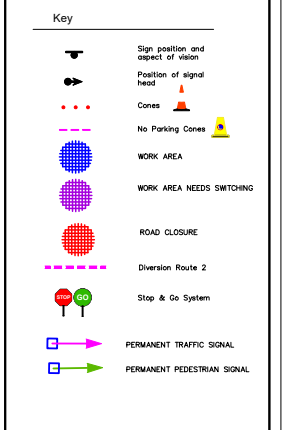

**THIS DRAWING MUST BE PRINTED IN COLOUR  
 ALL SIGNAGE TO BE IN WELSH AND ENGLISH**

NTS @ A3  
 NTS - OTHER SIZES  
**DO NOT SCALE FROM THIS DRAWING -  
 All Dimensions to be verified on site.**

REV	DATE	AS DRAWN	DESCRIPTION
A			



**TRAFFIC MANAGEMENT PLAN**

**Client:**

**Drawing Number:** QTM-398-03  
**Drawing Title:**  
 A442  
 NORTHBOUND  
 HOLLINSWOOD  
 TELFORD  
 TF3 2DE  
 LANE 1

Design:	Technical Officer:	REV
Name: C. DE-COURCY MSHE		
Signature:		A
Date: 05/10/2021		