

SAFETY, HEALTH AND ENVIRONMENTAL (SHE) INFORMATION
 In addition to the hazards/risks normally associated with the types of work detailed on this drawing, note the following:

CONSTRUCTION

- Utilities are present on this site, mainly within the verge, however some crossings are present including Gas, Electric, sewers and BT. Although utilities should not be affected by these works, please ensure safe working practices are followed when in the vicinity of utilities. Please refer to STATS plans provided for information.
- Underground structures noted on site. Trial holes will be required on top of underground structures prior to planning to confirm depth of cover.
- Overhead structures noted on site, height should not interfere with works, however Contractor to assess on site and ensure appropriate precautions against falling objects from above.
- CORING ONGOING: POTENTIAL TBM TO BE CONFIRMED FOLLOWING COMPLETION OF PAH TESTING**

MAINTENANCE / CLEANING
 - As above

ALTERATION / DEMOLITION
 - As above

It is assumed that all works will be carried out by a competent contractor working, where appropriate, to an approved method statement

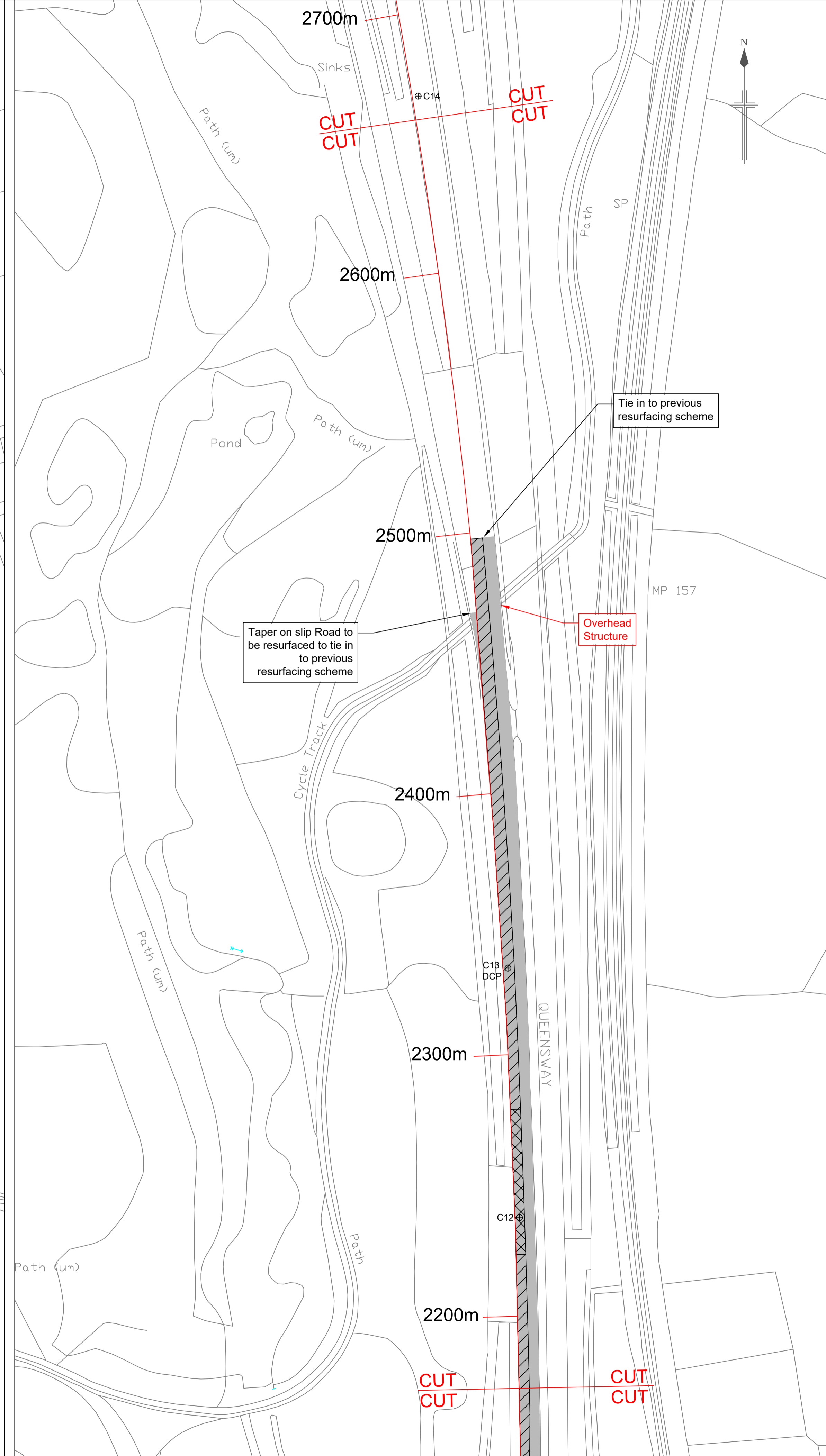
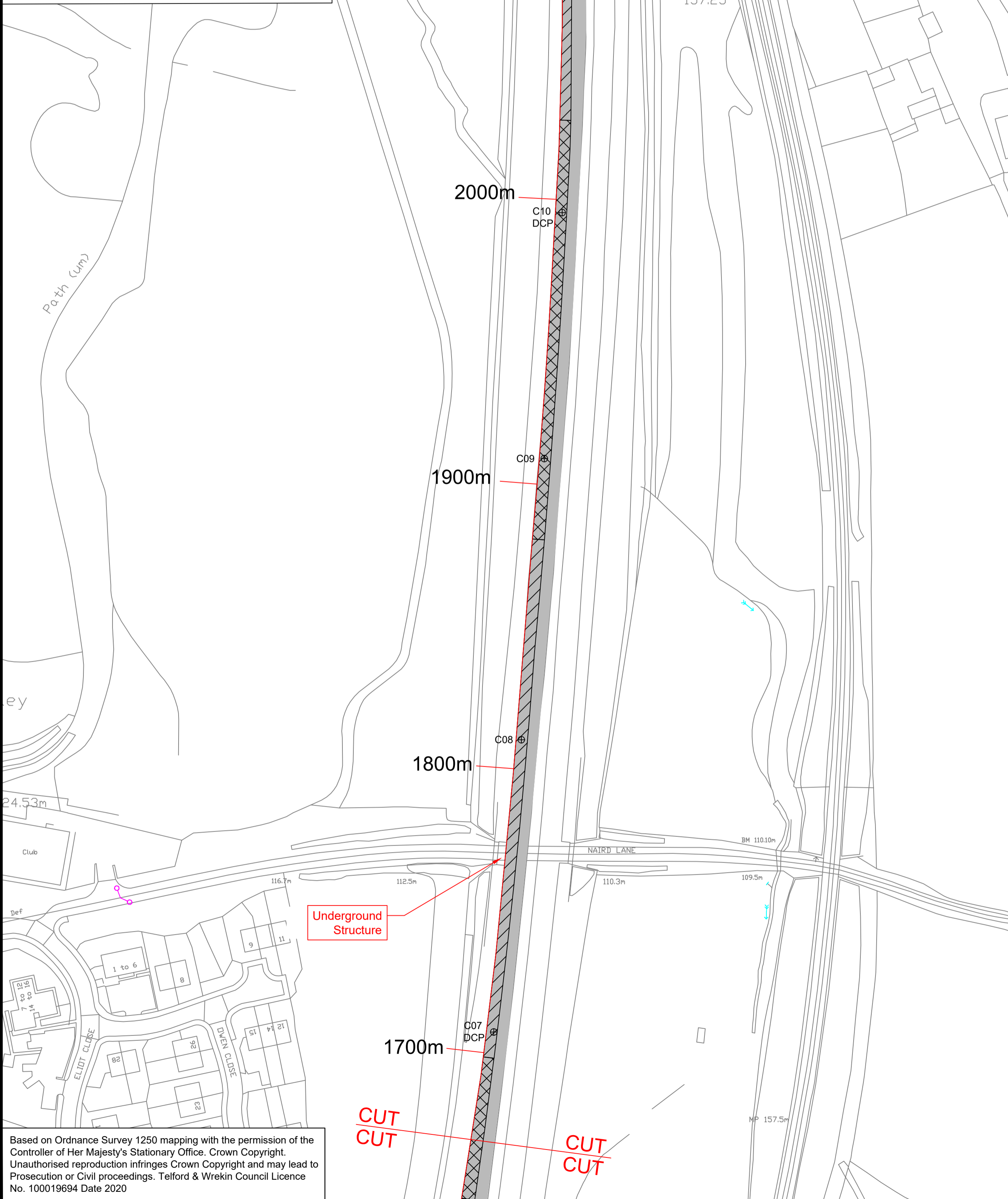

KEY - Resurfacing

	Plane 45mm and replace with: 45mm HRA 35/14 surf PMB, PSV 60 Clause 943
	Plane 95mm and replace with: 45mm HRA 35/14 surf PMB, PSV 60 Clause 943 50mm SMA 20 bin PMB MCHW Clause 937
	Plane 195mm and replace with: 45mm HRA 35/14 surf PMB, PSV 60 Clause 943 50mm SMA 20 bin PMB MCHW Clause 937 100mm AC32 HDM base 40/60 MCHW Clause 929
	Core Location

- NOTES - GENERAL**
- Do not scale from this drawing. If in doubt contact telford and wrekin council - highways, transportation and engineering (twc - hte).
 - All dimensions are in metres (m) unless otherwise noted.
 - This drawing is to be read in conjunction with all other relevant drawings relating to this project.
 - All dimensions should be checked on site prior to construction. Any discrepancies are to be immediately reported in writing to twc - hte.
 - The contractor shall, prior to construction, check and verify that the details shown on this drawing are fully compatible with any as constructed dimensions or levels. Any discrepancies are to be immediately reported in writing to twc - hte.
 - This drawing has been prepared for the exclusive use of the commissioning party and unless agreed in writing by twc - hte no other party may use or rely on its contents. No liability is accepted by twc - hte for any use of this drawing other than for the purpose for which it was originally prepared.
 - It should be noted that this drawing may include data provided by third parties. No liability is accepted by twc - hte as to the accuracy of this data.
 - This drawing shall not be reproduced in any way without the written permission of twc - hte.

- NOTES - CARRIAGEWAY**
- This drawing should only be read in relation to the subject of the title. Other information shown on the drawing is to be considered indicative only. Reference should be made to appropriate drawing series for other information.
 - All patching/resurfacing, kerbing and ironwork must be marked out in the presence of the Project Manager and agreed prior to the commencement of any works on site.
 - Bond Coat to MCHW Clause 920 is required at all bound layer interfaces within the pavement, this includes planed surfaces and new asphalt layers.
 - All joints, kerbs and ironwork must be cleaned of dust and debris and all vertical faces to be painted with bitumen prior to resurfacing.
 - Planed surface must be swept clean and inspected immediately following planing in order to determine the extents of any areas of deep patching. Any loose or delaminating material should be brought to the attention of the Project Manager and must also be removed.
 - All bituminous materials to be transported, laid and compacted in accordance with BS 5949:2015
 - All ironwork to BS EN 124:2015

Rev	Revision/Issue Date	Purpose of Revision/Issue	Drawn	Checked	Approved

Telford & Wrekin COUNCIL *Pride in Our Community*

Dean Sergeant, Director, Neighbourhood & Enforcement Services, Addenbrooke House, Telford, TF3 4NT

Client: Telford & Wrekin Council

Project: HM22/23 - A442 Brockton to Hollinswood

Drawing title: Carriageway Resurfacing Sheet 3 of 5

Drawing status: **D2 - FOR PRICING**

Scale: 1:1000	A1	Date: 16/05/2022	Drawn-by: SW	Checked-by: NL	Approved-by: AB
---------------	----	------------------	--------------	----------------	-----------------

DO NOT SCALE FROM THIS DRAWING

Drawing number: A442BRHO-TWC-HPV-01-DR-CH-0703

Rev: T1

Based on Ordnance Survey 1250 mapping with the permission of the Controller of Her Majesty's Stationary Office. Crown Copyright. Unauthorised reproduction infringes Crown Copyright and may lead to Prosecution or Civil proceedings. Telford & Wrekin Council Licence No. 100019694 Date 2020