

Balfour Beatty Highways Hub

To Residents,

Granville House
St Georges Road
Donnington Wood
Telford
TF27RA

Carriageway improvements in your area

Maddocks & Bridle Road, Madeley

Dear Resident,

As part of the Council's ongoing investment into its roads and footpaths, we will shortly be carrying out carriageway resurfacing works on Maddocks & Bridle Road, Madeley. Works will be completed by Balfour Beatty and specialist sub-contractors Tarmac & Quantum Traffic Management

When are we planning to deliver this work?

The work is due to take place on 04/09/2023 and be completed by 07/09/2023 (weekdays only) weather permitting. The works will be carried out under a Road Closure, which will be in place between 19:00-06:00. The closure on Bridle Road will be in place 24hr, on the section between Joseph Rich Avenue and Bridle Court.

Please find attached the diversion plan for these works.

We will have our dedicated teams on site to assist you during this time to help you get past the working areas safely should you need to do. Whilst we will endeavour to minimise disruption, we ask that you keep vehicle movements to an absolute minimum and not to park on the road. Please also ensure that children are supervised, do not play near the working areas and all pets are kept away from the works.

Information about access to your property

Access will be maintained during the works for residents and for emergency vehicles although there will be short periods of time when the contractors will require residential and commercial traffic to be excluded during planing of the road surface and to allow the surfacing material to harden. We will try to cause as little inconvenience as possible and really appreciate your co-operation whilst we are undertaking the works.

If you have any special access requirements while the works are in progress or need to contact Balfour Beatty about these improvements please contact us at our new Telford Highways Hub: TelfordHighways@Balfourbeatty.com and a member of our team will be in contact with you shortly.

Thank you for your co-operation whilst we deliver these improvements in your area.

These works are being delivered as part of the Council's investment programme to 'Protect, Care and Invest to create a better borough'. Over the next two years, over £21m is being invested to keep neighbourhoods safe, clean and well connected. The 'Pride in our Community' Highways Capital Programme will deliver improvements to infrastructure including roads, footpaths, parking, sustainable transport, street furniture, drains and structures.

Our highways vision is to 'Keep Telford Moving' and in 2023/2024 we will invest £13.732m to deliver a number of improvement schemes across the borough.

More Information about roadworks in Telford can be found at www.telford.gov.uk/roadworks

For more about the Council's Pride in Our Community programme visit www.telford.gov.uk/pride.

Balfour Beatty Telford Highways Hub- Working on behalf of Telford & Wrekin Council



Protect, care and invest
to create a better borough



Balfour Beatty

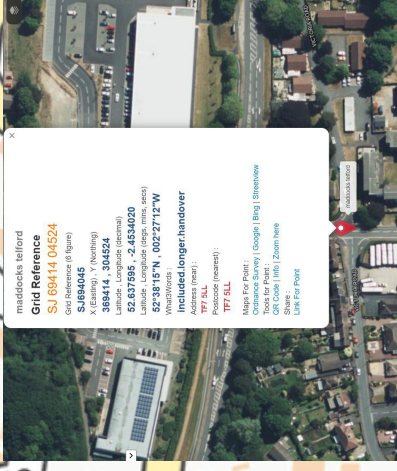
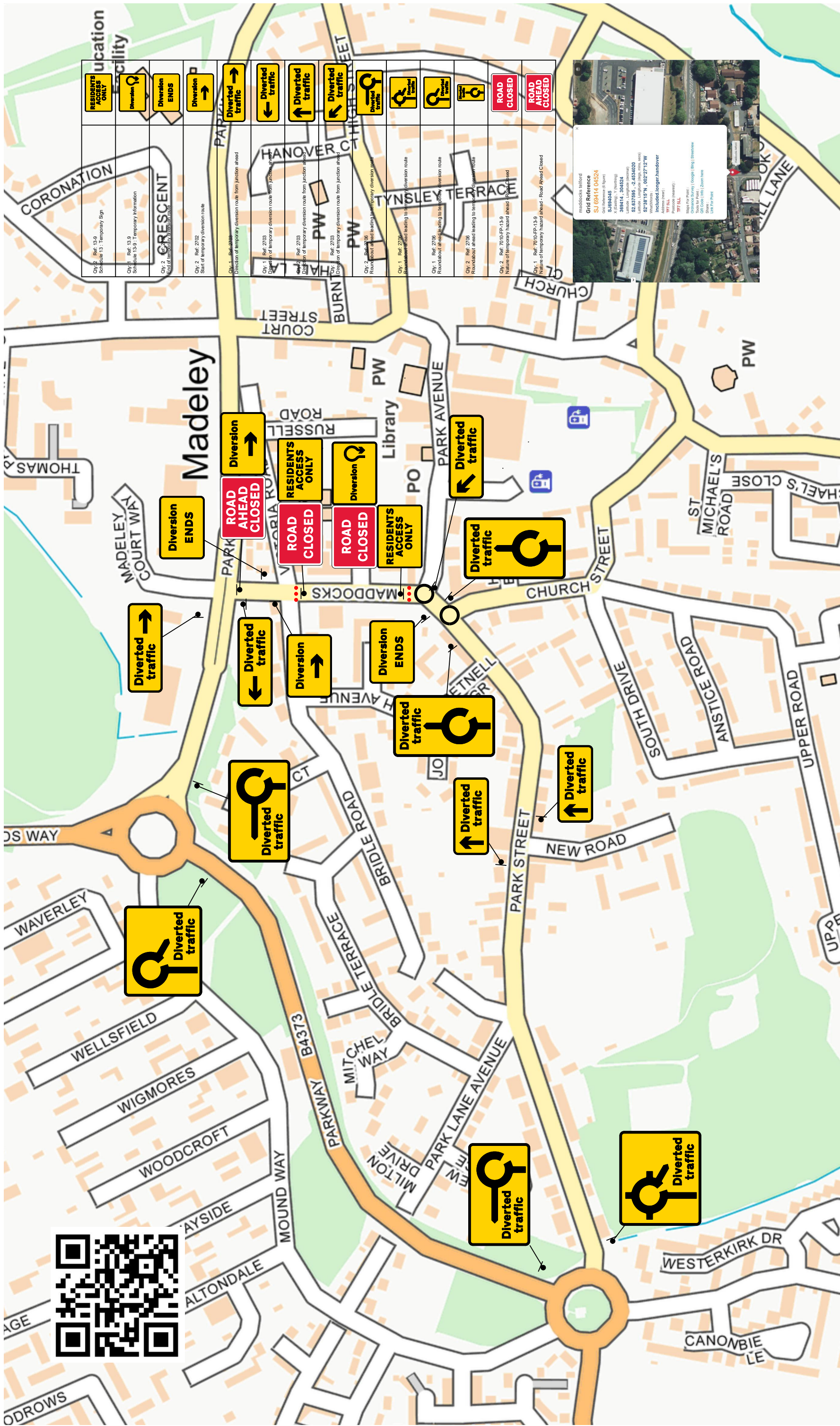

| | | | | | | | | | | | | | | | | | | | | | | | | | | | | | |
|---|--|---|---|--|--|--|--|--|---|---|---|---|---|---|---|---|---|---|---|---|---|---|---|---|---|---|---|---|---|
| Obj 1. Ref: 13-9 Schedule 13.9 - Temporary Sign RESIDENTS ACCESS ONLY | Obj 2. Ref: 13-9 Schedule 13.9 - Temporary Information Diversion | Obj 3. Ref: 2702 Start of temporary diversion route Diversion | Obj 4. Ref: 2703 End of temporary diversion route Diversion | Obj 5. Ref: 2703 Start of temporary diversion route from junction ahead Diverted traffic | Obj 6. Ref: 2703 End of temporary diversion route from junction ahead Diverted traffic | Obj 7. Ref: 2703 Start of temporary diversion route from junction ahead Diverted traffic | Obj 8. Ref: 2703 End of temporary diversion route from junction ahead Diverted traffic | Obj 9. Ref: 2703 Start of temporary diversion route from junction ahead Diverted traffic | Obj 10. Ref: 2703 End of temporary diversion route from junction ahead Diverted traffic | Obj 11. Ref: 2703 Start of temporary diversion route from junction ahead Diverted traffic | Obj 12. Ref: 2703 End of temporary diversion route from junction ahead Diverted traffic | Obj 13. Ref: 2703 Start of temporary diversion route from junction ahead Diverted traffic | Obj 14. Ref: 2703 End of temporary diversion route from junction ahead Diverted traffic | Obj 15. Ref: 2703 Start of temporary diversion route from junction ahead Diverted traffic | Obj 16. Ref: 2703 End of temporary diversion route from junction ahead Diverted traffic | Obj 17. Ref: 2703 Start of temporary diversion route from junction ahead Diverted traffic | Obj 18. Ref: 2703 End of temporary diversion route from junction ahead Diverted traffic | Obj 19. Ref: 2703 Start of temporary diversion route from junction ahead Diverted traffic | Obj 20. Ref: 2703 End of temporary diversion route from junction ahead Diverted traffic | Obj 21. Ref: 2703 Start of temporary diversion route from junction ahead Diverted traffic | Obj 22. Ref: 2703 End of temporary diversion route from junction ahead Diverted traffic | Obj 23. Ref: 2703 Start of temporary diversion route from junction ahead Diverted traffic | Obj 24. Ref: 2703 End of temporary diversion route from junction ahead Diverted traffic | Obj 25. Ref: 2703 Start of temporary diversion route from junction ahead Diverted traffic | Obj 26. Ref: 2703 End of temporary diversion route from junction ahead Diverted traffic | Obj 27. Ref: 2703 Start of temporary diversion route from junction ahead Diverted traffic | Obj 28. Ref: 2703 End of temporary diversion route from junction ahead Diverted traffic | Obj 29. Ref: 2703 Start of temporary diversion route from junction ahead Diverted traffic | Obj 30. Ref: 2703 End of temporary diversion route from junction ahead Diverted traffic |
|---|--|---|---|--|--|--|--|--|---|---|---|---|---|---|---|---|---|---|---|---|---|---|---|---|---|---|---|---|---|

| Quantum Traffic Management | | Drn: PV | Balfour Beatty | | Drawing No: QTM-PV-BB-5002 | |
|----------------------------|---------|---------------------------|----------------|--|----------------------------|--------------|
| www.quantumtm.co.uk | Chk: SL | Maddocks, Telford TF7 5LL | | Drawing: Traffic management arrangement for Road Closure and Diversion | | |
| +44 (0) 01978280144 | App | Date: 06/03/23 | | CONE-XXXXX | | |
| Balfour Beatty | | Rev | Drn: | Chk | App | Scale: N.T.S |
| | Date: | | | | | |
| Description | Date | | | | | |

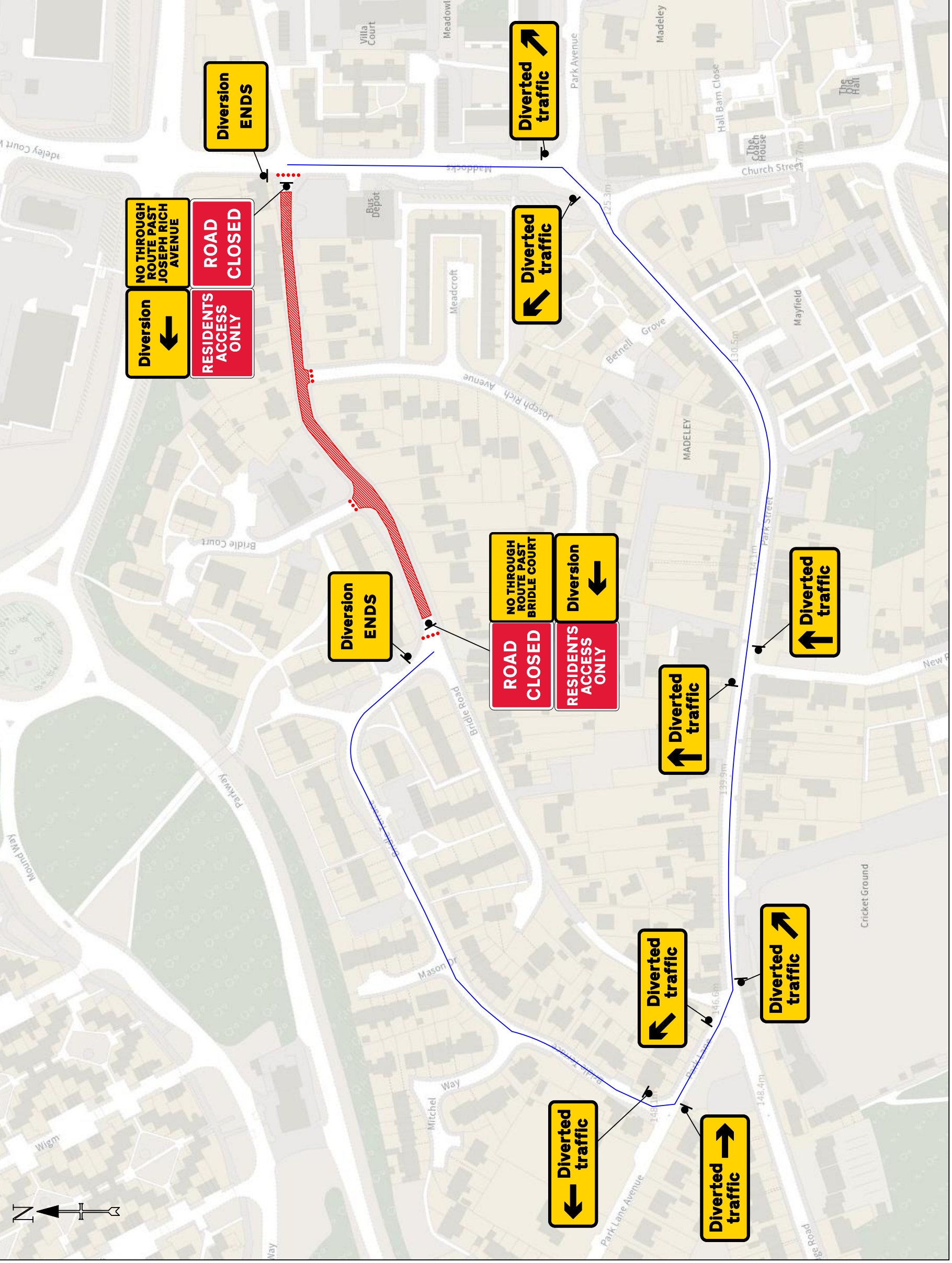

Required Kit

| | |
|--|---|
| Qty: 2 Ref: 13-9 Schedule 13 : Temporary Sign | RESIDENTS ACCESS ONLY |
| Qty: 1 Ref: 13-9 Schedule 13 : Temporary Sign | NO THROUGH ROUTE PAST JOSEPH RICH AVENUE |
| Qty: 1 Ref: 13-9 Schedule 13 : Temporary Sign | NO THROUGH ROUTE PAST BRIDLE COURT |
| Qty: 2 Ref: 2702 Start of temporary diversion route | Diversion ← |
| Qty: 2 Ref: 2702 End of temporary diversion route | Diversion ENDS |
| Qty: 2 Ref: 2703 Direction of temporary diversion route from junction ahead | Diverted traffic ↗ |
| Qty: 2 Ref: 2703 Direction of temporary diversion route from junction ahead | Diverted traffic ↖ |
| Qty: 2 Ref: 2703 Direction of temporary diversion route from junction ahead | Diverted traffic ↑ |
| Qty: 1 Ref: 2703 Direction of temporary diversion route from junction ahead | Diverted traffic → |
| Qty: 1 Ref: 2703 Direction of temporary diversion route from junction ahead | Diverted traffic ← |
| Qty: 2 Ref: 7010-FP-13-9 Nature of temporary hazard ahead - Road Closed | ROAD CLOSED |

Job Location QR Code & 3 Words



- LEDGE
- POTATO
- GRUB

| |
|--|
| Drawing No: QTM-PV-BB-5033 |
| Drawing: Traffic management arrangement for Road Closure and Diversion |
| CONE-XXXXX |
| Scale: N.T.S |

| Rev | Drn: | Chk | App | Description | Date |
|-----|------|-----|-----|-------------|------|
| | | | | | |

Balfour Beatty

Site Location
Bridle Road, Woodside, Madeley, Telford and Wrekin, England, TF7 5ET

| | |
|-------|----------|
| Drn: | PV |
| Chk: | SL |
| App | |
| Date: | 21/06/23 |

Quantum Traffic Management
www.quantumtm.co.uk
+44 (0) 01978280144

