

Balfour Beatty Highways Hub

To Residents,

Granville House  
St Georges Road  
Donnington Wood  
Telford  
TF27RA

## Carriageway improvements in your area

### High Street, Madeley (including surrounding areas)

Dear Resident,

As part of the Council's ongoing investment into its roads and footpaths, we will shortly be carrying out carriageway resurfacing works on High Street, Court Street, Parkway, Tynsley Terrace, Tynsley Court and The Rookery, Madeley. Works will be completed by Balfour Beatty and specialist sub-contractors Tarmac & Quantum Traffic Management.

#### When are we planning to deliver this work?

The work is due to take place on 15/09/2023 and be completed by 02/10/2023 (weekdays only) weather permitting. Please see the below breakdown for the phasing of these works:

#### **Phase 1**

##### High Street:

15/09-23/09 – Road Closure in place between 19:00-06:00

##### Court Street (North of the traffic lights heading towards the ski slope):

15/09/23 – Road Closure – 23:00-03:00

18/09/23 – Multi-Way Lights – 22:00-03:00

19/09/23 – No traffic management in place

20/09/23 – Road Closure – 19:00-06:00

21/09/23-23/09/23 – Multi-Way Lights – 19:00-06:00

##### Parkway Junction:

15/09/23 – Road Closure – 23:00-03:00

18/09/23 – Multi-Way Lights – 22:00-03:00

19/09/23 – No traffic management in place

20/09/23 – Road Closure – 19:00-06:00

21/09/23-23/09/23 – Multi-Way Lights – 19:00-06:00

## **Phase 2**

Court Street (from High Street heading towards the traffic lights):

26/09-02/10 – Road Closure – 08:00-18:00

Tynsley Terrace, Tynsley Court & The Rookery

26/09-02/10 – Road Closure – 08:00-18:00

Please find attached the proposed diversion routes for these works.

We will have our dedicated teams on site to assist you during this time to help you get past the working areas safely should you need to do. Whilst we will endeavour to minimise disruption, we ask that you keep vehicle movements to an absolute minimum and not to park on the road. Please also ensure that children are supervised, do not play near the working areas and all pets are kept away from the works.

### Information about access to your property

Access will be maintained during the works for residents and for emergency vehicles although there will be short periods of time when the contractors will require residential and commercial traffic to be excluded during planing of the road surface and to allow the surfacing material to harden. We will try to cause as little inconvenience as possible and really appreciate your co-operation whilst we are undertaking the works.

**If you have any special access requirements while the works are in progress or need to contact Balfour Beatty about these improvements please contact us at our new Telford Highways Hub: [TelfordHighways@Balfourbeatty.com](mailto:TelfordHighways@Balfourbeatty.com) and a member of our team will be in contact with you shortly.**

Thank you for your co-operation whilst we deliver these improvements in your area.

**These works are being delivered as part of the Council's investment programme to 'Protect, Care and Invest to create a better borough'. Over the next two years, over £21m is being invested to keep neighbourhoods safe, clean and well connected. The 'Pride in our Community' Highways Capital Programme will deliver improvements to infrastructure including roads, footpaths, parking, sustainable transport, street furniture, drains and structures.**

**Our highways vision is to 'Keep Telford Moving' and in 2023/2024 we will invest £13.732m to deliver a number of improvement schemes across the borough.**

More Information about roadworks in Telford can be found at [www.telford.gov.uk/roadworks](http://www.telford.gov.uk/roadworks)

For more about the Council's Pride in Our Community programme visit [www.telford.gov.uk/pride](http://www.telford.gov.uk/pride).

**Balfour Beatty Telford Highways Hub- Working on behalf of Telford & Wrekin Council**



Protect, care and invest  
to create a better borough



**Balfour Beatty**

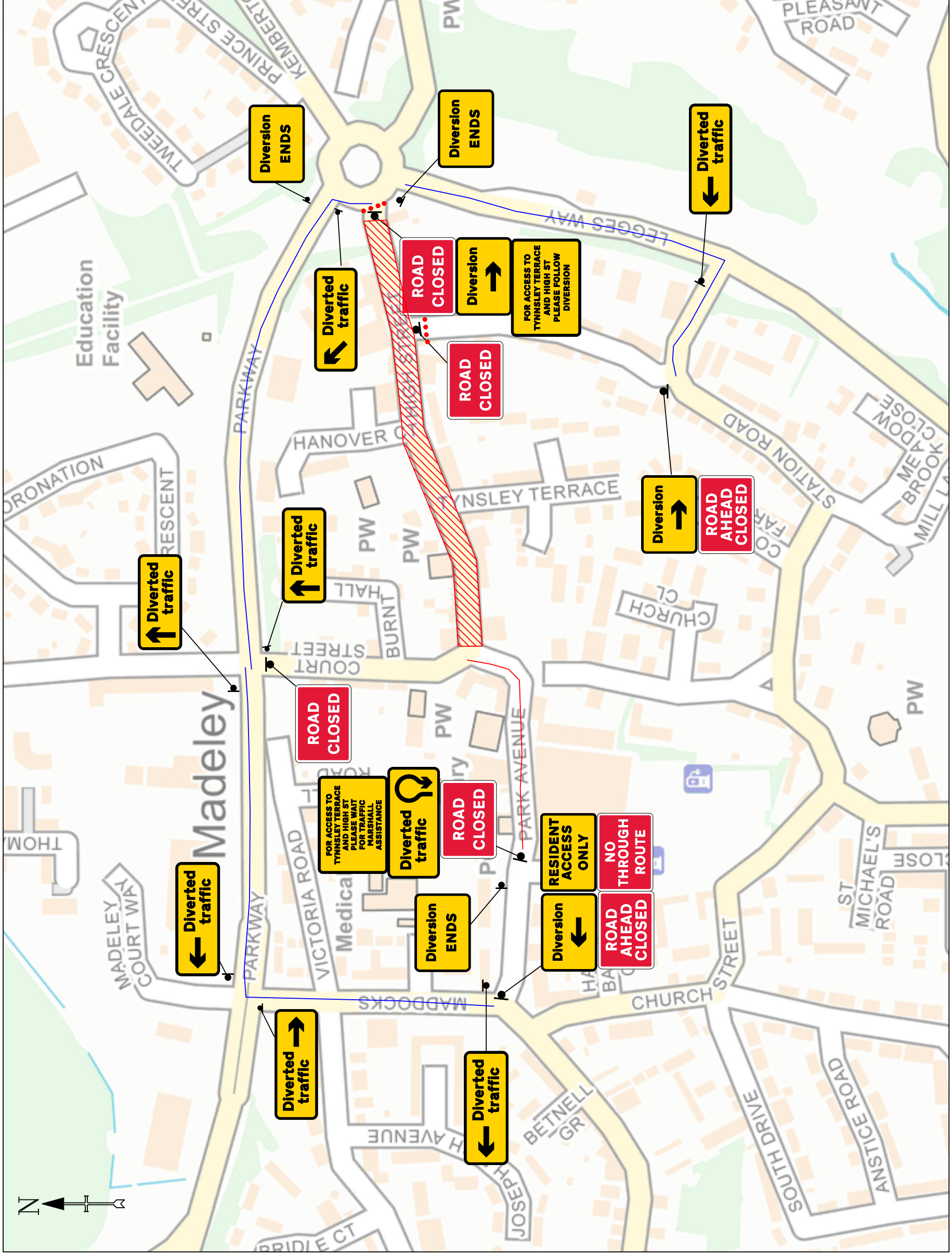
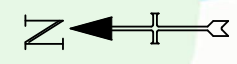

**Required Kit**

City: 1 Ref: 13.9 Schedule 13.9 : Temporary Information	
City: 1 Ref: 13.9 Schedule 13.9 : Temporary Information	
City: 1 Ref: 13.9 Schedule 13.9 : Temporary Information	
City: 1 Ref: 13.9 Schedule 13.9 : Temporary Information	
City: 2 Ref: 27.02 Start of temporary diversion route	
City: 1 Ref: 27.02 Start of temporary diversion route	
City: 3 Ref: 27.02 End of temporary diversion route	
City: 1 Ref: 27.03 Direction of temporary diversion route U-turn at roundabout ahead	
City: 1 Ref: 27.03 Direction of temporary diversion route from junction ahead	
City: 1 Ref: 27.03 Direction of temporary diversion route from junction ahead	
City: 3 Ref: 27.03 Direction of temporary diversion route from junction ahead	
City: 2 Ref: 27.03 Direction of temporary diversion route from junction ahead	
City: 4 Ref: 7010-FP:13-9 Nature of temporary hazard ahead - Road Closed	
City: 2 Ref: 7010-FP:13-9 Nature of temporary hazard ahead - Road Ahead Closed	

Job Location QR Code & 3 Words

- ATOMS
- EASED
- SOMEBODY

Quantum Traffic Management		Drn: PV	Balfour Beatty		Drawing No: QTM-PV-BB-5037	
www.quantumtm.co.uk		Chk: SL	Site Location		Drawing: Traffic management arrangement for Road Closure and Diversion	
+44 (0) 01978280144		App	High Street, Hills Lane, Madeley, Telford and Wrekin, England, TF7 5AU		CONE-XXXXX	
Date: 21/06/23		Date			Scale: N.T.S	
		Rev	Description			
		Drn:	App			
		Chk	Chk			
		App	App			





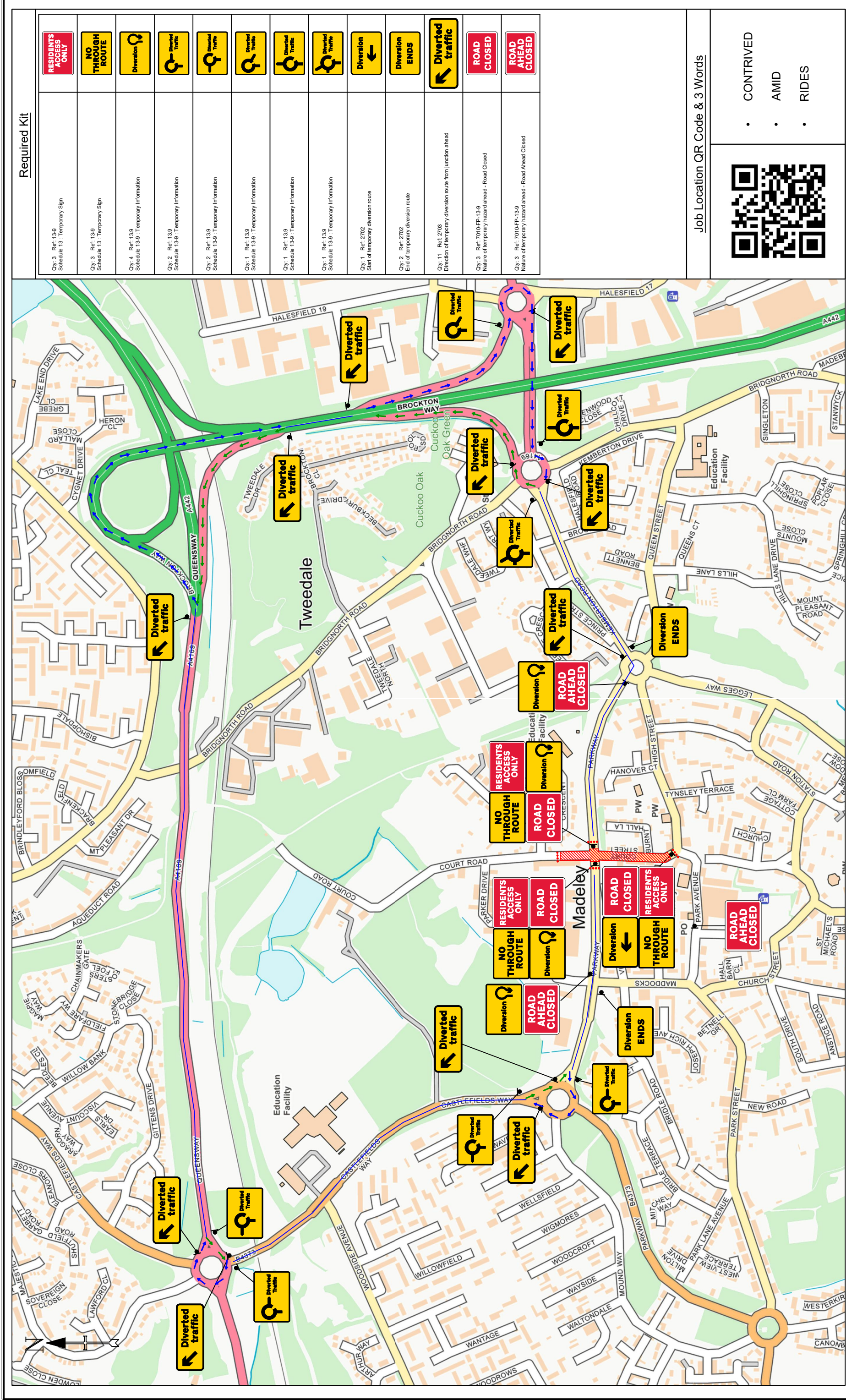

**Required Kit**

Qty: 3 Ref: 13-9 Schedule 13: Temporary Sign	
Qty: 3 Ref: 13-9 Schedule 13: Temporary Sign	
Qty: 4 Ref: 13-9 Schedule 13-9: Temporary Information	
Qty: 2 Ref: 13-9 Schedule 13-9: Temporary Information	
Qty: 2 Ref: 13-9 Schedule 13-9: Temporary Information	
Qty: 1 Ref: 13-9 Schedule 13-9: Temporary Information	
Qty: 1 Ref: 13-9 Schedule 13-9: Temporary Information	
Qty: 1 Ref: 13-9 Schedule 13-9: Temporary Information	
Qty: 1 Ref: 2702 Start of temporary diversion route	
Qty: 2 Ref: 2702 End of temporary diversion route	
Qty: 11 Ref: 2703 Direction of temporary diversion route from junction ahead	
Qty: 3 Ref: 7010-PE-13-9 Nature of temporary hazard ahead - Road Closed	
Qty: 3 Ref: 7010-PE-13-9 Nature of temporary hazard ahead - Road Ahead Closed	

Job Location QR Code & 3 Words



- CONTRIVED
- AMID
- RIDES

Drawing No:  
QTM-PV-BB-5038

Drawing: Traffic management arrangement for Road Closure and Diversion

Rev	Drn:	Chk	App	Description	Date

**Balfour Beatty**

Site Location  
Court Street, Sutton Hill, Madeley, Telford and Wrekin, England, TF7 5EP

Drn:	PV
Chk:	SL
App	
Date:	21/06/23

Quantum Traffic Management  
www.quantumtm.co.uk  
+44 (0) 01978280144



Scale: N.T.S