

Rear of residential gardens (G1-01 continued)  
Turf to be laid to area shown.  
Reinstatement of garden boundary and any planting damaged during the works to be separately agreed. Works to be supervised by the landscape clerk of works.

Scale 1:500 @ A1

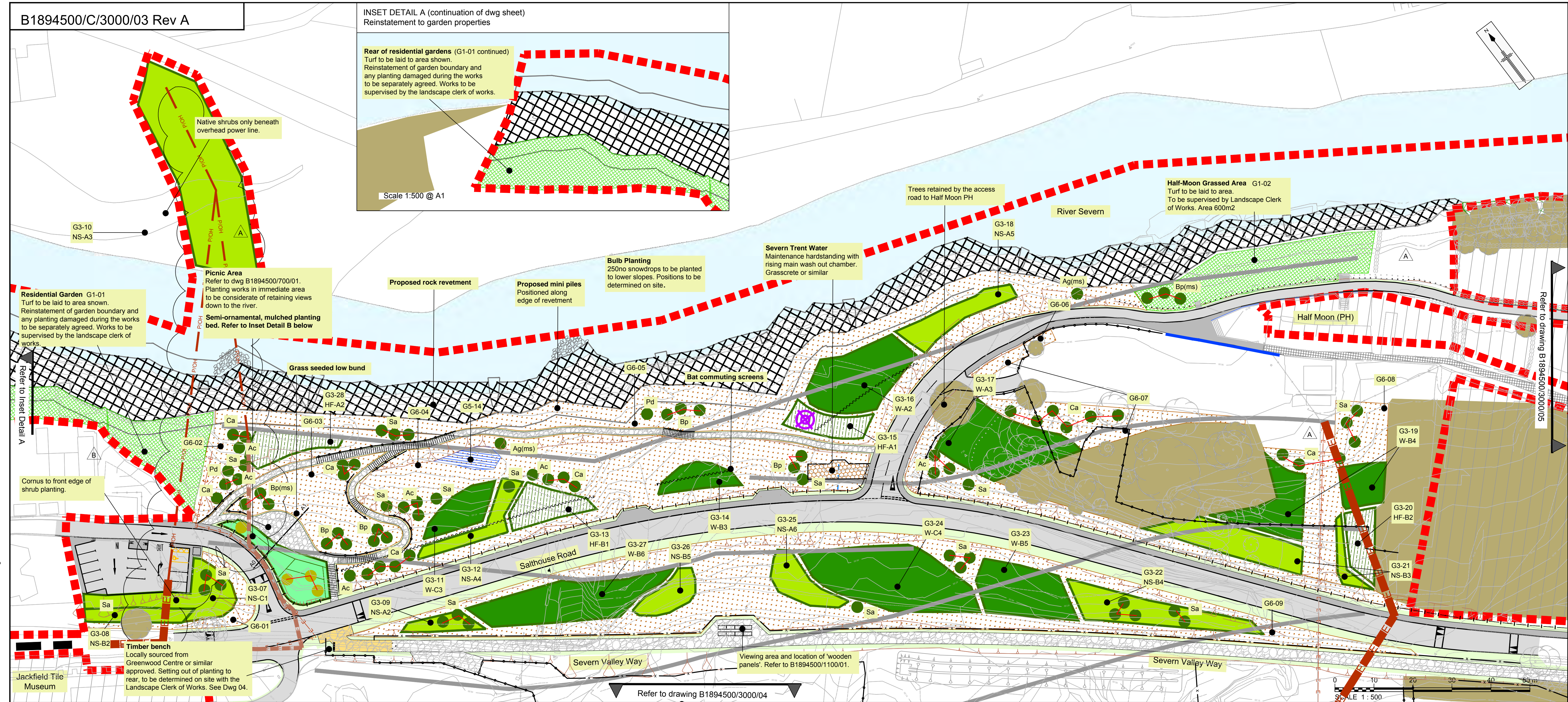

Based on Ordnance Survey 1250 mapping with the permission of the Controller of Her Majesty's Stationary Office. Crown Copyright.  
Unauthorised reproduction infringes Crown Copyright and may lead to Prosecution or Civil proceedings.  
Telford & Wrekin Council Licence No. 100019694 Date 2010  
Contour Information based on Lidar Data.

Note: Works should reference all utility information.  
Refer to Drawing B1894500/2700/01

For plant information and schedules see  
drawings B1894500/3000/07 to 09.

KEY

- Existing trees, hedges and scrub retained
- Works boundary
- Area excluded from works
- Overhead electricity diversion
- Underground electricity diversion
- Existing formal public rights of way
- Cast Iron 3-rail fence
- Strained wire fence with single wooden rail
- Chestnut pale fenceline
- Post & Three rail
- Woven wire fence (stockproof)
- Timber birds-mouth knee rail
- Piling Works

- Rock revetment, locally enhanced with bio-engineered features
- Soft bank stabilisation, largely comprised of bio-engineered features
- LE 2.1 Native woodland planting
- LE 2.3 High forest
- LE 2.6 Shrubs
- LE 2.7 Scattered trees
- LE 3.2 Ornamental shrubs
- LE5.1 Individual Trees
- LE 1.1 Amenity Grass Areas
- LE 1.3 Species rich grassland
- LE 6.4 Marsh & wet grassland
- Grass Turf Mix

- Improved field drainage / swales  
Refer to Dwg 3000/01 for further information
- Permanent bat commuting screens
- Receptor site [LE2.1 & edge of woodland areas] for saved understorey plants to be translocated into. See Ecological Mitigation Strategy: Vol 2 / Mitigation.
- Japanese Knotweed (JKW) remediation bunds planting only carried out once clear of JKW. (See Japanese Knotweed Mitigation Strategy)

- Bitumen highway
- Bitumen footway
- Unbound footpath
- Reinforced unbound footpath
- Reinforced earth access track

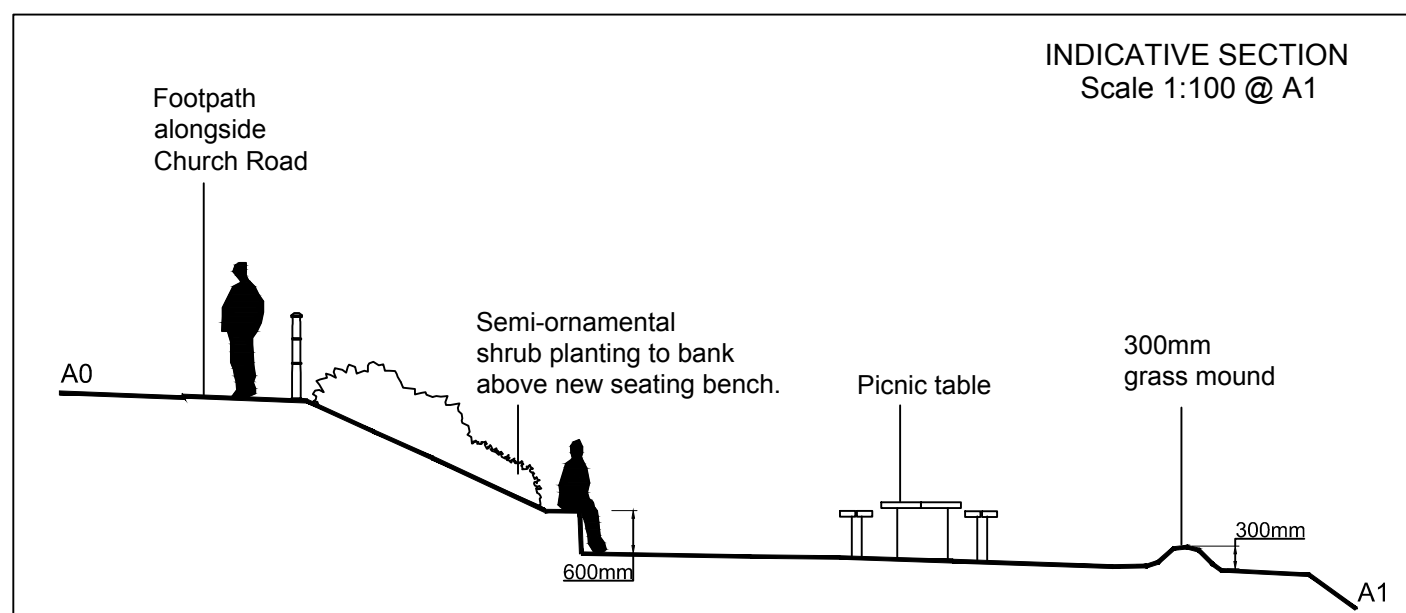

INSET DETAIL B - CHURCH ROAD PLANTING

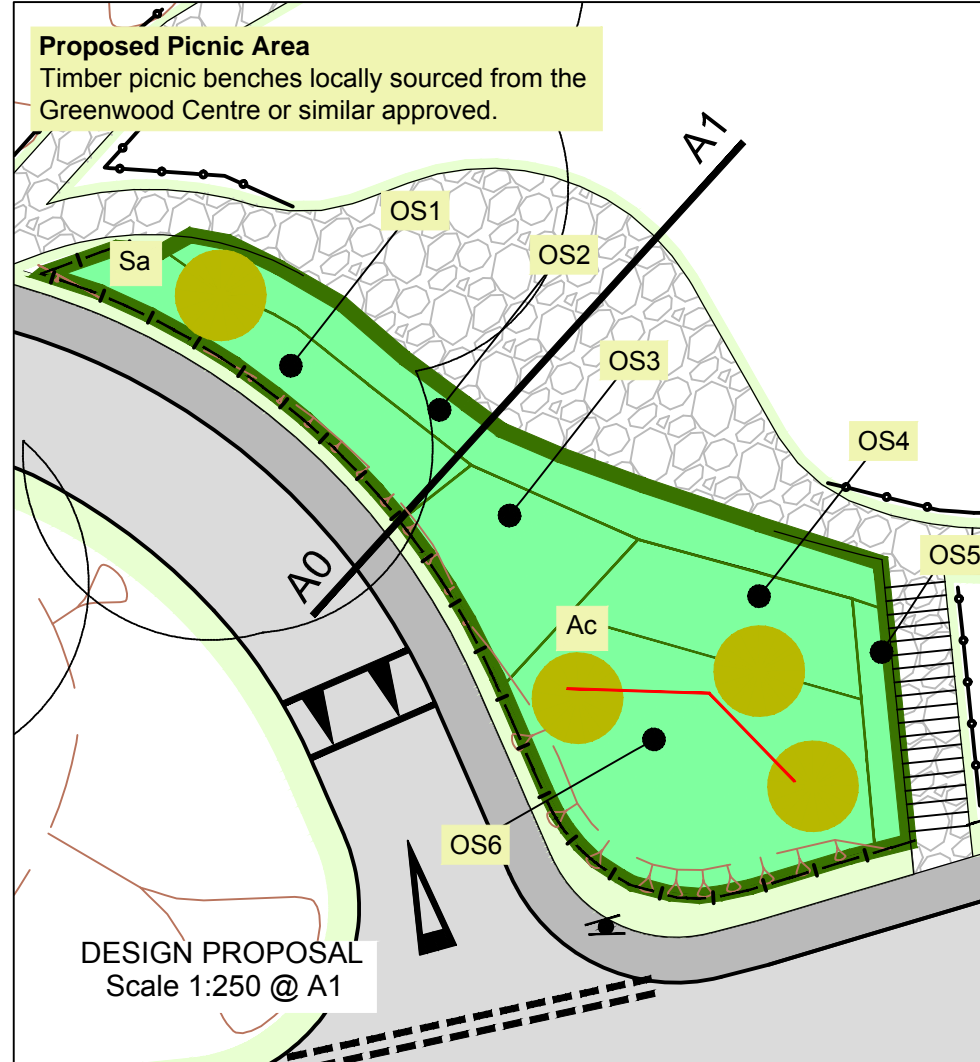

SCHEMATIC LOCATION PLAN

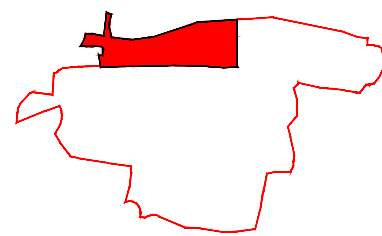

SAFETY HEALTH AND ENVIRONMENTAL INFORMATION

IN ADDITION TO THE HAZARD/RISKS NORMALLY ASSOCIATED WITH THE TYPES OF WORK DETAILED ON THIS DRAWING. NOTE THE FOLLOWING SIGNIFICANT RESIDUAL RISKS:-

CONSTRUCTION

CLOSE TO RIVER.  
CLOSE TO JAPANESE KNOTWEED AREAS  
SLIPS & FALLS RISK  
LEPTOSPIROSIS (WEIL'S DISEASE)  
VEHICLE MOVEMENTS - RISK TO LABOURERS

POSSIBLE PRESENCE OF ADDER

MAINTENANCE/CLEANING/OPERATION  
CARE TO BE TAKEN ON EMBANKMENT SLOPE AND AROUND RIVER EDGE/POND.  
NEW SEATING AREAS - LITTER/GLASS DEBRIS

DECOMMISSIONING/DEMOLITION

COPICING WORK & GENERAL ARBORICULTURAL WORK IN THE FUTURE, WILL BE CLOSE TO THE PUBLIC FOOTWAYS AND FOOTPATHS.

POSSIBLE RE-EMERGENCE OF JAPANESE KNOTWEED

| Rev | Rev. Date  | Purpose of revision   | Drawn | Checked | Rev'd | Appr'd |
|-----|------------|---|-------|---------|-------|--------|
| A   | 09/04/2014 | SITE BOUNDARY AMENDED AROUND PROPERTY 145 & GRASS REMOVED. TREES REMOVED. OVERHEAD LINES AND BOUNDARY ALTERED TO SUIT WESTERN POWER | WRG   | TS      | TS    | DL     |
| 0   |            | NOT ISSUED  |       |         |       |        |

|   |  |
|---|--|
| JACOBS  |  |
| Hollinswood House, Stafford Court, Stafford Park 1, Telford, Shropshire, TF3 3DD<br>Tel: +44(0)1952 236 500 Fax: +44(0)1952 236 501<br>www.jacobs.com |  |

|         |                          |
|---------|--------------------------|
| Client  | Telford & Wrekin COUNCIL |
| Project | JACKFIELD STABILISATION  |

|               |  |
|---------------|--|
| Drawing title | LANDSCAPE DESIGN<br>LOWER SLOPES<br>3 OF 6 |
|---------------|--|

|                |                    |
|----------------|--------------------|
| Drawing status | FOR CONSTRUCTION   |
| Scale          | As Shown           |
| Jacobs No.     | B1894500           |
| Client no.     |                    |
| Drawing number | B1894500/C/3000/03 |
| Rev            | A                  |

This drawing is not to be used in whole or part other than for the intended purpose and project as defined on this drawing. Refer to the contract for full terms and conditions.